



M&M Manufacturing Company

www.mmmfg.com

AUSTIN
(512)-960-2370

DALLAS
(972)-485-1504

FORT WORTH
(Adolph)
(817)-334-0034

FORT WORTH
(MKIV)
(817)-336-2311

HOUSTON
(713)-690-0585

LITTLE ROCK
(501)-888-3042

PROPRIETARY INFORMATION
THIS DRAWING AND/OR DATA SHEET, AND THE CONFIDENTIAL PROPRIETARY INFORMATION THEREON, ARE THE PROPERTY OF M&M MANUFACTURING, INC. AND ARE NOT TO BE REPRODUCED OR COPIED IN WHOLE OR IN PART, OR USED FOR UNAUTHORIZED MANUFACTURING OR ANY OTHER EXPLOITATION OF THE ITEM DISCLOSED THEREIN, OR IN ANY OTHER WAY DISCLOSED OR USED FOR FURNISHING INFORMATION.

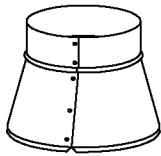

#505(size)

Conical metal spin-in starting collar

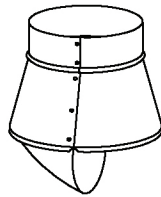

#505X(size)

Conical metal spin-in starting collar with scoop

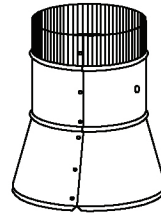

#505H(size)

Conical metal spin-in starting collar with holes for damper

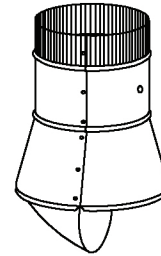

#505HX(size)

Conical metal spin-in starting collar with holes for damper and scoop

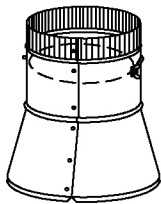

#505D(size)

Conical metal spin-in starting collar with damper

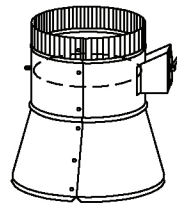

#505D(size)ELV142

Conical metal spin-in starting collar with damper and 1/4" regulator on 2" stand-off

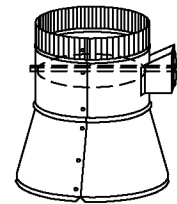

#505D(size)ELV382

Conical metal spin-in starting collar with damper, continuous rod and 3/8" regulator on 2" stand-off

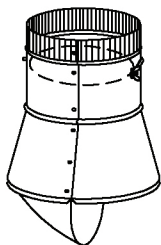

#505DX(size)

Conical metal spin-in starting collar with damper and scoop

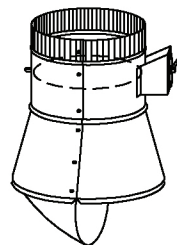

#505DX(size)ELV142

Conical metal spin-in starting collar with damper, 1/4" regulator on 2" stand-off and scoop

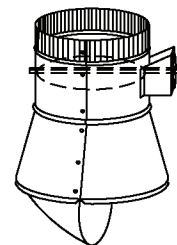

#505DX(size)ELV382

Conical metal spin-in starting collar with damper, continuous rod, 3/8" regulator on 2" stand-off and scoop

PART #: See above **DESCRIPTION:** Conical metal spin-in starting collars / Styles

NOTES: Material: 4" - 14" = 28 ga.; 16" - 18" = 26 ga.; 20" = 24 ga.

ASTM-A653 CS B galvanized steel

4" W.C. Positive Pressure Commercial SMACNA Gauge

Order by Pt# as listed above